

## NERLITE® LT430 BL 150x200 LED Backlight Series

**Description:** NERLITE LT430 Backlight Series (patent pending) provide sharp contrast to outline a part's shape, find edges and view openings such as drilled holes, allowing for various vision operations. In a low-profile industrial package providing optimal thermal management to the LEDs, models in the 150X200 series are a cost effective choice for applications where illuminated area size and uniformity are of importance. NERLITE LT430 Backlights are available in various wavelengths for strobe or continuous duty-cycles, all using industry standard M12 connectors.

**Applications:** Back lighting: to outline a parts shape, find edges, or detect openings (e.g. drilled holes).

Part #	Description
6GF3910-0AF00-3AF0	NERLITE LT430 BL 150x200, R LED-D, CC
6GF3910-0AF00-3AG0	NERLITE LT430 BL 150x200, W LED-D, CC
6GF3910-0AF00-3AC0	NERLITE LT430 BL 150x200, B LED-D, CC
6GF3910-0AF00-3AH0	NERLITE LT430 BL 150x200, G LED-D, CC
6GF3910-0AF00-3AJ0	NERLITE LT430 BL 150x200, I LED-D, CC

**Description Key Example**

**BL 00x00, R LED-D, 24V-C**

Family Designation: BL - Backlight	Color: R - Red W - White B - Blue G - Green I - Infrared	Delivery: D - Diffused	Power: xxV-C - DC Volts Continuous CC - Constant Current
Backlight Size (mm - approx)		Source: LED - Light Emitting Diode	



### Illumination & Electrical:

#### Light Characteristics:

Source	Color (nm)	Exp. Life	CC-Strobe <sup>1, 2, 3, 4</sup>			CC-Continuous <sup>1, 2, 4</sup>		
			Max. Current	Max. Vf	Min. Vf	Max. Current	Max. Vf <sup>5</sup>	Min. Vf <sup>5</sup>
LED	Red (625)	50k hrs.	1.50 A peak	17.16 V	11.32 V	1.05 A	14.04 V	9.24 V
LED	Blue (470)	50k hrs.	1.43 A peak	17.04 V	11.92 V	1.05 A	15.96 V	11.16 V
LED	Green (530)	50k hrs.	1.43 A peak	17.04 V	11.92 V	1.05 A	15.96 V	11.16 V
LED	IR (850)	50k hrs.	2.00 A peak	15.54 V	9.72 V	1.40 A	14.40 V	9.00 V
LED	White - 5500 Kelvin	50k hrs.	1.43 A peak	17.04 V	11.92 V	1.05 A	15.96 V	11.16 V

<sup>1</sup> CAUTION: Do not connect "CC" (Constant Current) lights directly to 24 volts; use a CC controller or driver.

<sup>2</sup> 24VDC +/- 3% is the recommended input to PP6xx controllers for CC-Strobe models;

24VDC +/- 10% is the recommended input to LCxx drivers.

<sup>3</sup> Maximum pulse width = 1ms, maximum frequency = 60Hz

<sup>4</sup> Exceeding max. current, pulse width or frequency voids product warranty.

<sup>5</sup> Vf = Forward Voltage in Volts DC; used in calculating heat dissipation in CC-Continuous applications that use a PP6xx controller.

**CE Conformity:** Yes  
**Lighting Technique:** Diffuse Backlight  
**Active Area:** 150mm x 200 mm  
 (5.91 in. x 7.87 in.)

### Environmental:

**Max. Operating Humidity:** 85% non-condensing  
**Operating Temp.:** 40°C (104°F)  
**Storage Temp.:** 50°C (122°F)

### Mechanical:

**L x W x H (mm/in.):**

170.0 mm x 260.0 mm x 23.5 mm

(6.69 in. x 10.24 in. x 0.93 in.)

(4) 4.3 mm [0.17 in.] thru holes

Black Anodized Aluminum

Weight: 1.5 kgs. (3.4 lbs.)

**Mounting:**  
**Housing Material:**  
**Weight:**

### Connectors:

**Connector Type:**

M12 "A" Code Male, 4 Pos:

Pin # 1 = +  
 Pin # 2 = nc  
 Pin # 3 = -  
 Pin # 4 = nc  
 Connector Shell = Shield

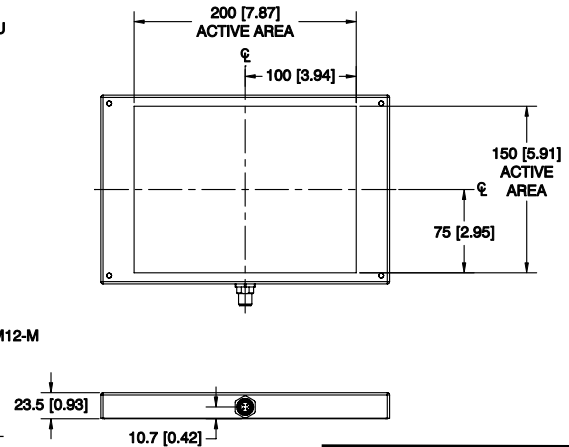
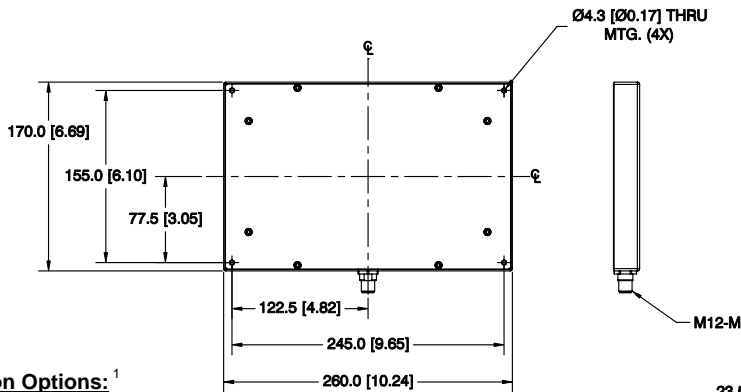

### Installation Options:<sup>1</sup>

Part #	Description	Used on Models
6GF3910-1BA10-0AS0	PP600, 2 Chnl. CC Cntrl, 24VDC, Push Button <sup>2, 3</sup>	LT430 CC-Strobe
6GF3910-1BA10-0AT0	PP610, 2 Chnl. CC Cntrl, 24VDC, PB/RS232 <sup>2, 3</sup>	LT430 CC-Strobe
6GF3910-1BA10-0AD0	LC50, 1.4A CC Driver, w/Terminal Block <sup>2</sup>	LT430 CC-Continuous
6GF3910-1BA10-0AC0	LC50 1.05 A CC Driver, w/Terminal Block <sup>2</sup>	LT430 CC-Continuous
6GF3910-1BA10-0AL0	LC100 1.05 A CC Driver, w/Terminal Block <sup>2</sup>	LT430 CC-Continuous
6GF3910-1BA00-0AA0	DSP60, 24VDC, 2.5A DIN Mount Power Supply	PP6xx, LC50, & LC100
6GF3910-1BA00-0AB0	DSP100, 24VDC, 4.2A DIN Mount Power Supply	PP6xx, LC50, & LC100
6GF3910-1DA00-0AB0	AC Power Cord, US, 1.8 M (6.0 ft.)	DIN Mount PS
6GF3910-1DA00-0AC0	AC Power Cord, EU, 2.5 M (8.2 ft.)	DIN Mount PS
6GF3910-1DA00-0AD0	AC Power Cord, UK, 2.0 M (6.6 ft.)	DIN Mount PS
6GF3910-1DA00-0AA0	Power Cable, Flying Leads - M12F, 3.0 M (9.8 ft.)	LT430 (all)

<sup>1</sup> Constant Current (CC) controller or driver is required.

<sup>2</sup> CC controllers and drivers require a DC power supply; choose one from above.

<sup>3</sup> Refer to [PP600 Heat Dissipation application note](#) if considering CC-Continuous mode applications (not recommended).

For further product family information see:  
<http://www.nerlite.com>  
 Illumination uniformity graphs are available at...  
<http://www.nerlite.com/pdfs/lt430-uniformity.pdf>



NERLITE LT430 BL 150x200-6598xx 121007

