

SPECIFICATIONS

PRODUCT SPECIFICATIONS



**DIGITAL CCD AREA SCAN
COLOR OR MONOCHROME
RS-644, IEEE 1394 OR
CAMERA LINK™ OUTPUT
UP TO 14.8 FPS AT 1.4 MEGAPIXELS**

BASLER A100 SERIES

Features/Benefits

- Superior image quality improves your image processing results
- Super compact size reduces the space needed in your installation
- Choice of three output types maximizes your system design flexibility
- 100% factory testing ensures consistent product quality
- Test image generation capability reduces your integration time and aids troubleshooting
- Area of Interest (AOI) scanning allows higher frame rates
- Low smear feature improves your performance when using a pinpoint light source
- Electronic exposure time control provides maximum flexibility

Description

The A100 Series of high-performance, digital cameras is ideal for a variety of industrial applications. The cameras can be triggered via an external sync signal or run in an internally controlled "free-run" mode. A100 cameras operate with a single voltage power supply and have simple cabling requirements. A combination of features such as binning, low smear, test images, and indicator LEDs, ensure that these versatile cameras provide an exceptional price/performance ratio.

Applications

- Semiconductor and component inspection
- Manufacturing quality control
- Traffic control
- Food and beverage inspection
- Microscopy and medical imaging
- Many other vision applications

BASLER
VISION TECHNOLOGIES

Dimensions (in mm)

A101 (RS-644)

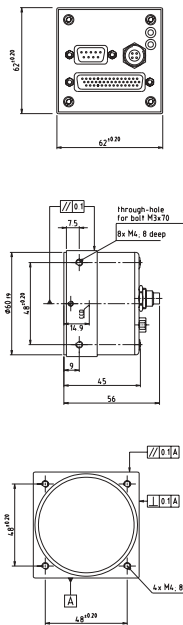

A101f (IEEE 1394)

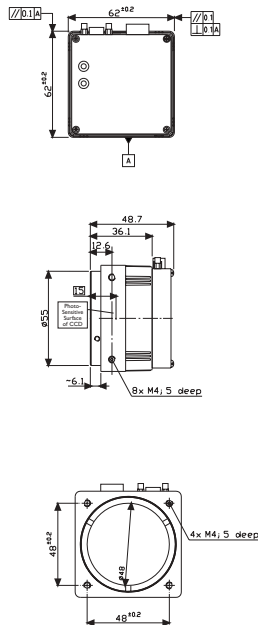

A102k (Camera Link)

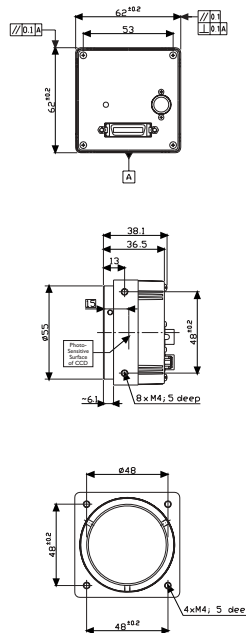

A102f/fc (IEEE 1394)

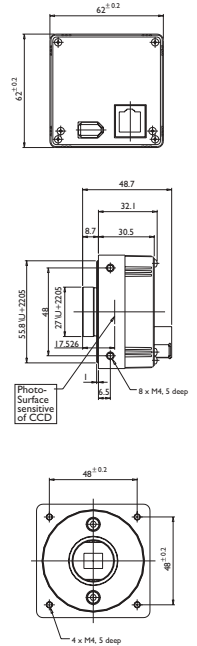

| Specifications | A101/c | A101f/fc | A102k | A102f/fc |
|------------------------------------|-------------------------------------|----------------------------------------------------------|-------------------------------------|-------------------------------------------------------------------|
| Sensor Size (H x V Pixels) | 1300 x 1030 | 1300 x 1030 | 1392 x 1040 | 1392 x 1040 |
| Sensor Type | | | Progressive Scan CCD | |
| Pixel Size (in µm) | 6.7 x 6.7 | 6.7 x 6.7 | 6.45 x 6.45 | 6.45 x 6.45 |
| Pixel Clock | 18 MHz | Not Applicable | 28 MHz | Not Applicable |
| Max. Frame Rate at Full Resolution | 11.75 frames/s | 12 frames/s | 14.8 frames/s | 15 frames/s |
| Color / Mono | Color or Mono | Color or Mono | Mono Only | Color or Mono |
| Video Output Type | RS-644 LVDS | IEEE 1394 | Camera Link (Base)* | IEEE1394 |
| Video Output Format | Single Pixel 8 bits | Mono: 8 bits/pixel Color: YUV 4:2:2 or raw data | Single Pixel 8 or 10 bits | Mono: 8 or 16 (12 bit/pixel) Color: YUV4:2:2 or raw data |
| Synchronization | Via external trigger or free-run | Via external trigger, via the 1394 bus or free run | Via external trigger or free-run | Via external trigger, via the 1394 bus or free run |
| Exposure Control | Level-controlled or programmable | Programmable via the 1394 bus | Level-controlled or programmable | Programmable via the 1394 bus |
| Power Requirements | 24VDC (±10%) max. 5.0 W | 12VDC (±10%) max. 5.0 W | 12VDC (±10%) max. 3.5 W | 8-40 VDC, max. 4.0 W (at 12 VDC) |
| Lens Mounts | C-mount or F-mount | C-mount or F-mount | C-mount or F-mount | C-mount |
| Housing Size (L x W x H) | 45 mm x 62 mm x 62 mm | 48.7 mm x 62 mm x 62 mm | 38.1 mm x 62 mm x 62 mm | 40.8 mm x 62 mm x 62 mm |
| Weight | max. 380 g | max. 310 g | max. 292 g | ca. 240 g |
| Conformity | | | CE, FCC | |

Specifications are subject to change without prior notice.

*The output is RS-644 LVDS when this camera is used with an optional Basler Interface Converter (BIC)



Germany, Headquarters
Phone +49 4102 463 500
Fax +49 4102 463 599
vc.sales.europe@baslerweb.com

USA
Phone +1 610 280 0171
Fax +1 610 280 7608
vc.sales.usa@baslerweb.com

Singapore
Phone +65 6425 0472
Fax +65 6425 0473
vc.sales.asia@baslerweb.com

www.basler-vc.com